

FAG H32/500-HG参数

尺寸	$d_{1H}$	470	mm	-
	$D_m$	630	mm	-
	$l$	428	mm	-
	$c$	80	mm	-
	$c_1$	99	mm	-
	$d$	500	mm	-
	$d_{2G}$	Tr500x5	mm	-
	$e$	6.5	mm	-
	$R_o$	M8		-
	$t$	12	mm	-
说明		470	mm	轴
		HM31/500		型号, 螺母
		MS31/500		型号, 止动装置
		M16X25		型号, 六角头螺栓
重量	$m$	170000	g	质量

FAG H32/500-HG图片

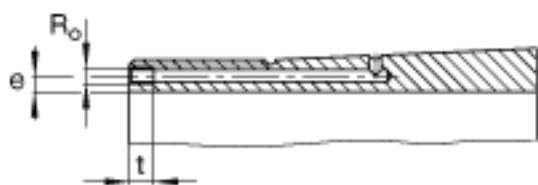

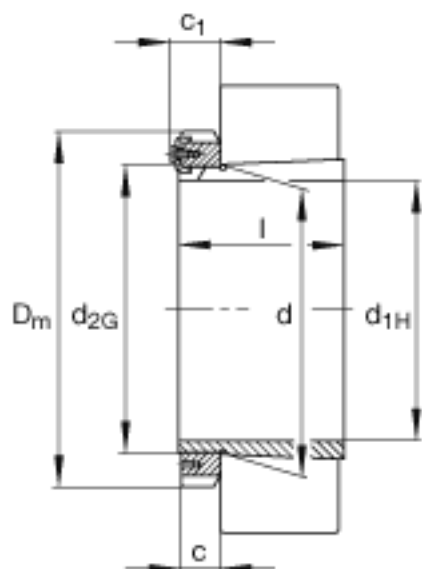

参考资料:<http://www.sozhou.com/p/79cc7cc6.html>